

## **Appendix A8**

### Build Alternative Construction Staging and Workzone Safety & Mobility

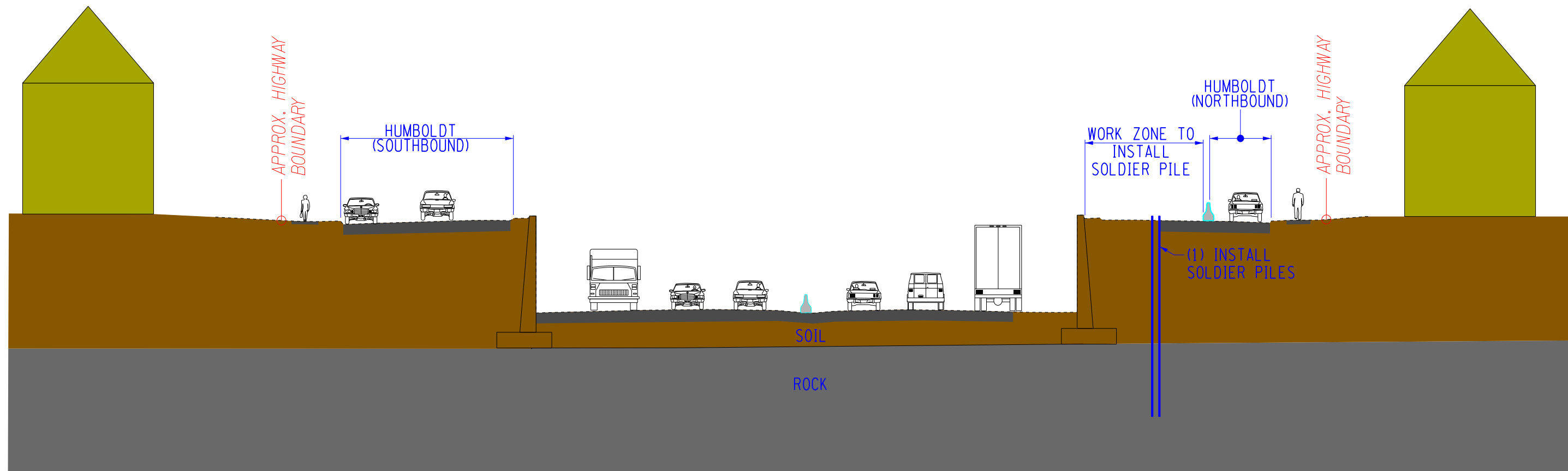

STAGE 1 - CONSTRUCT EASTBOUND TUNNEL WALLS AND ROADWAY

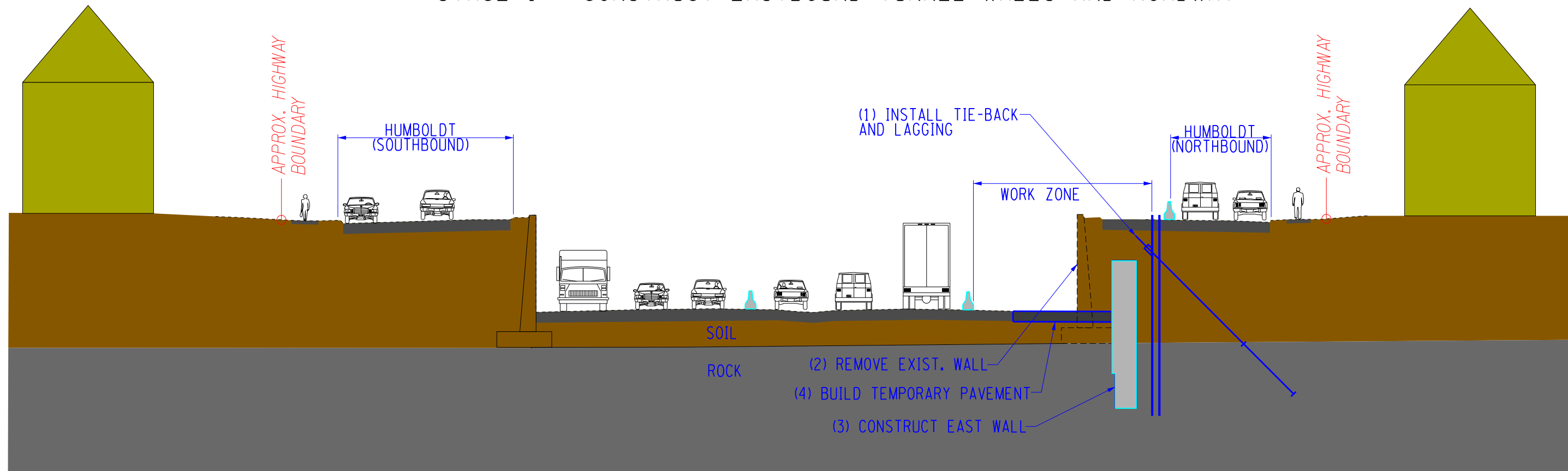

STAGE 2 - CONSTRUCT EASTBOUND TUNNEL WALLS AND ROADWAY

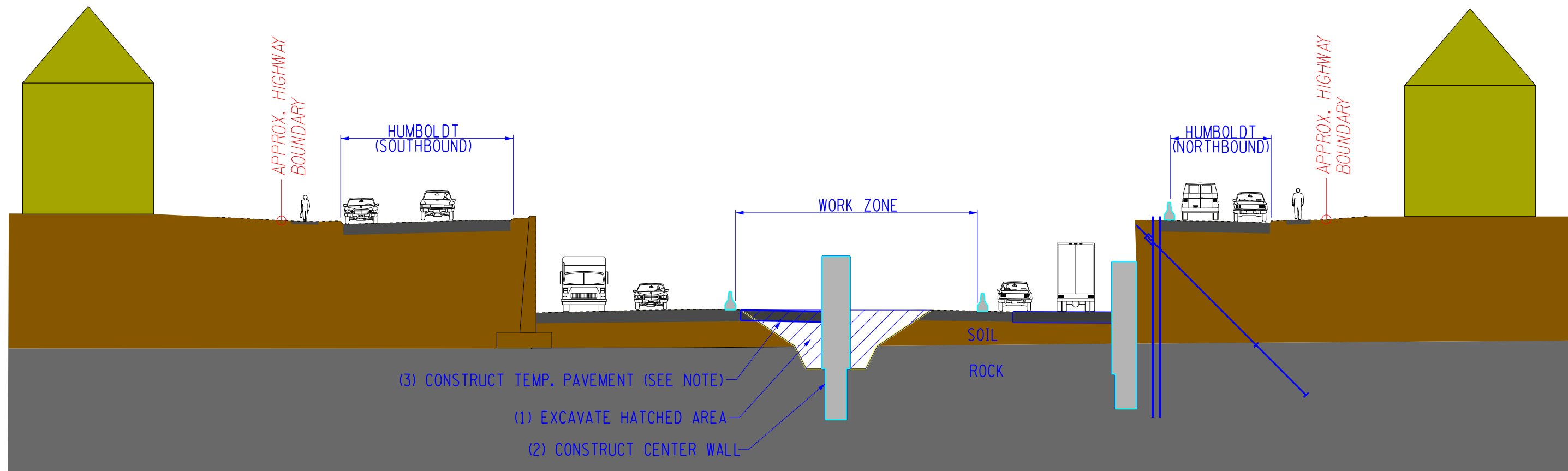

NOTE: TEMP. PAVEMENT IS REQUIRED FOR STAGE 4 TRAFFIC

### STAGE 3 - CONSTRUCT EASTBOUND TUNNEL WALLS AND ROADWAYS

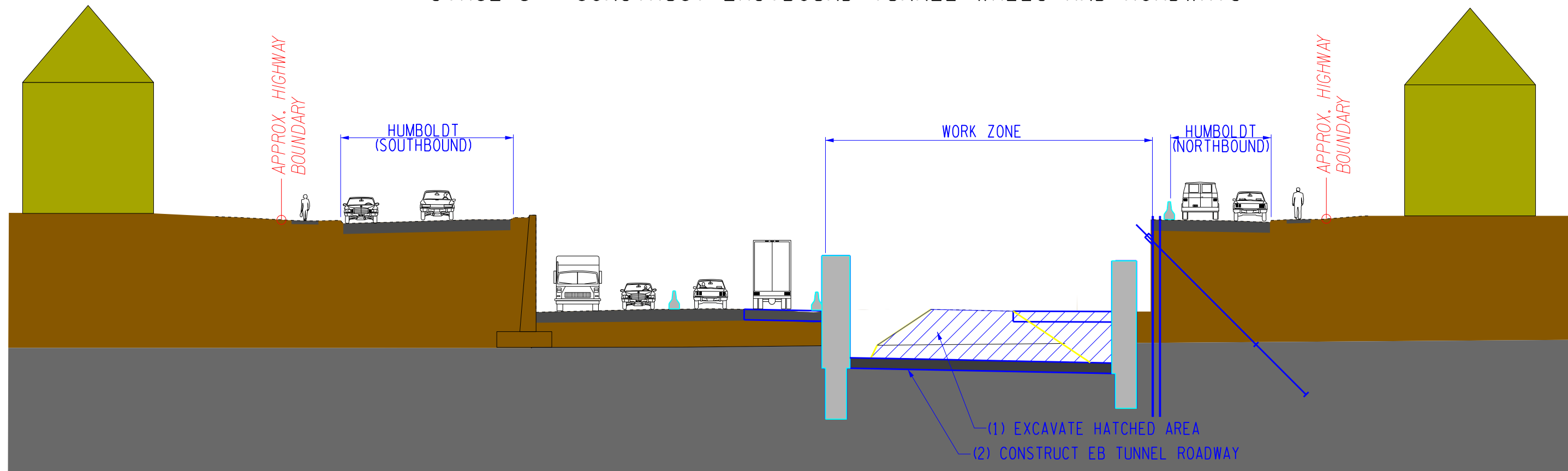

### STAGE 4 - CONSTRUCT EASTBOUND TUNNEL WALLS AND ROADWAY

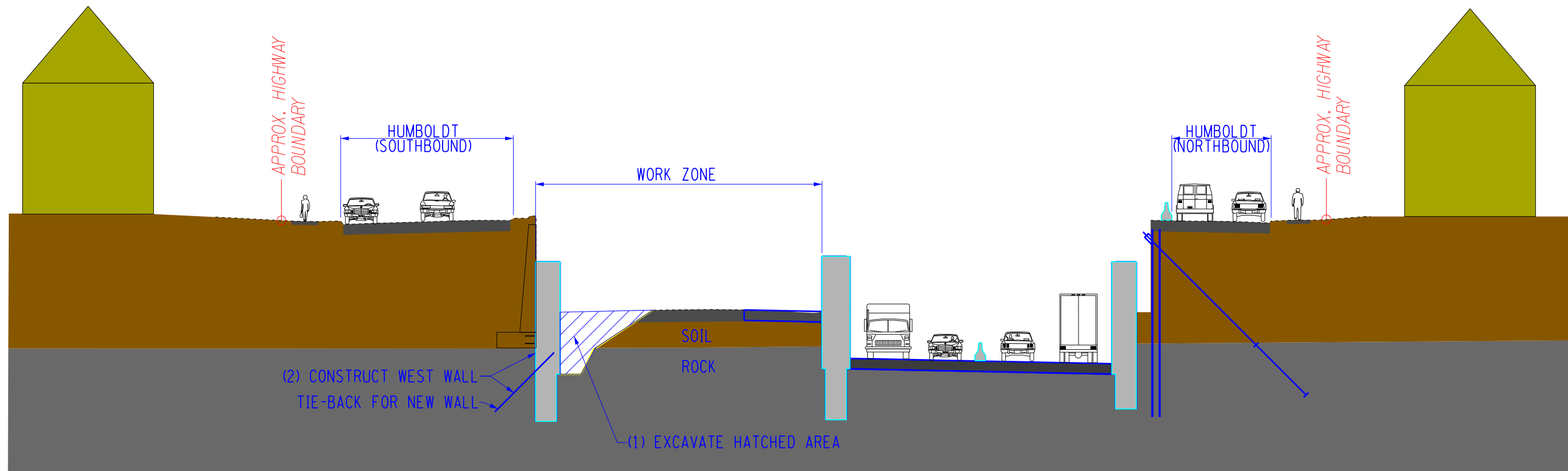

STAGE 5 - CONSTRUCT WESTBOUND TUNNEL

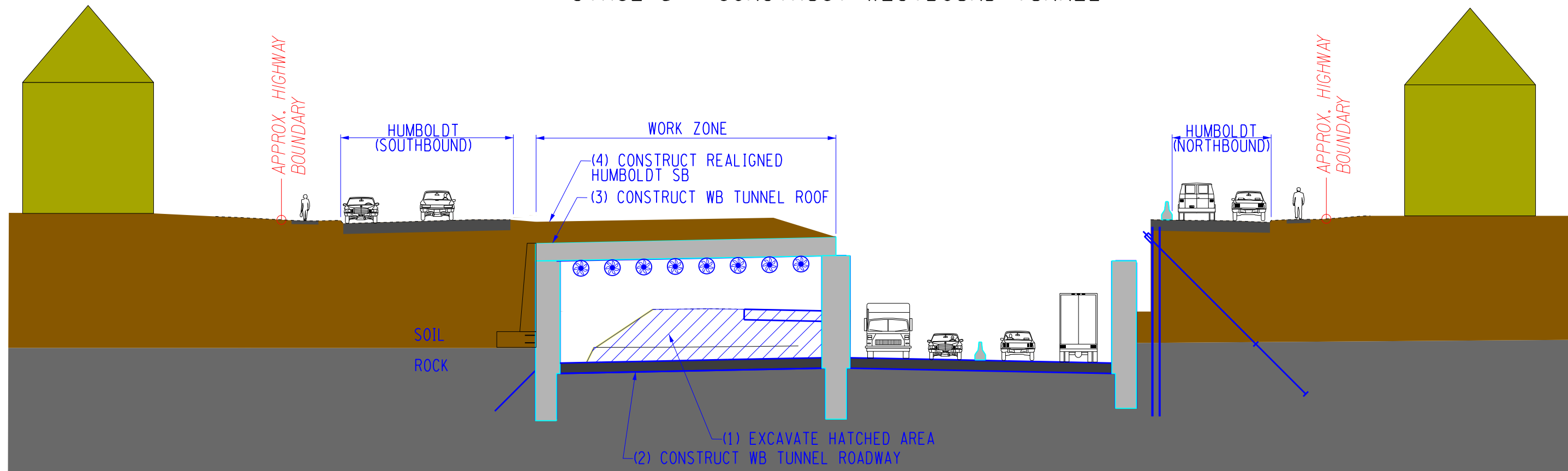

STAGE 6 - COMPLETE WESTBOUND TUNNEL

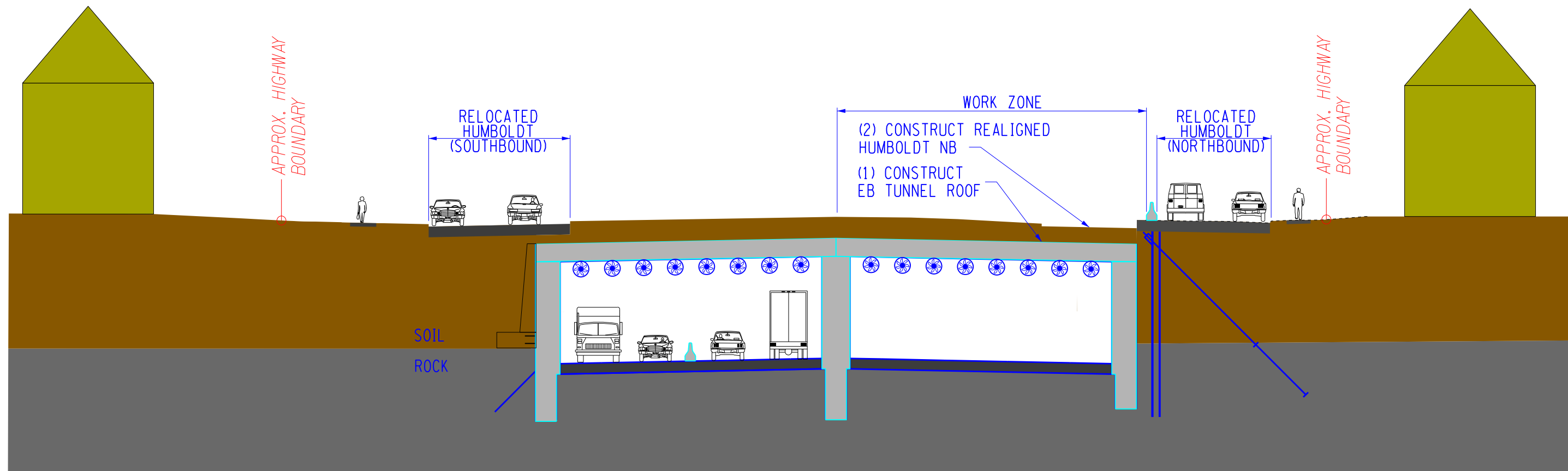

STAGE 7 - COMPLETE EASTBOUND TUNNEL

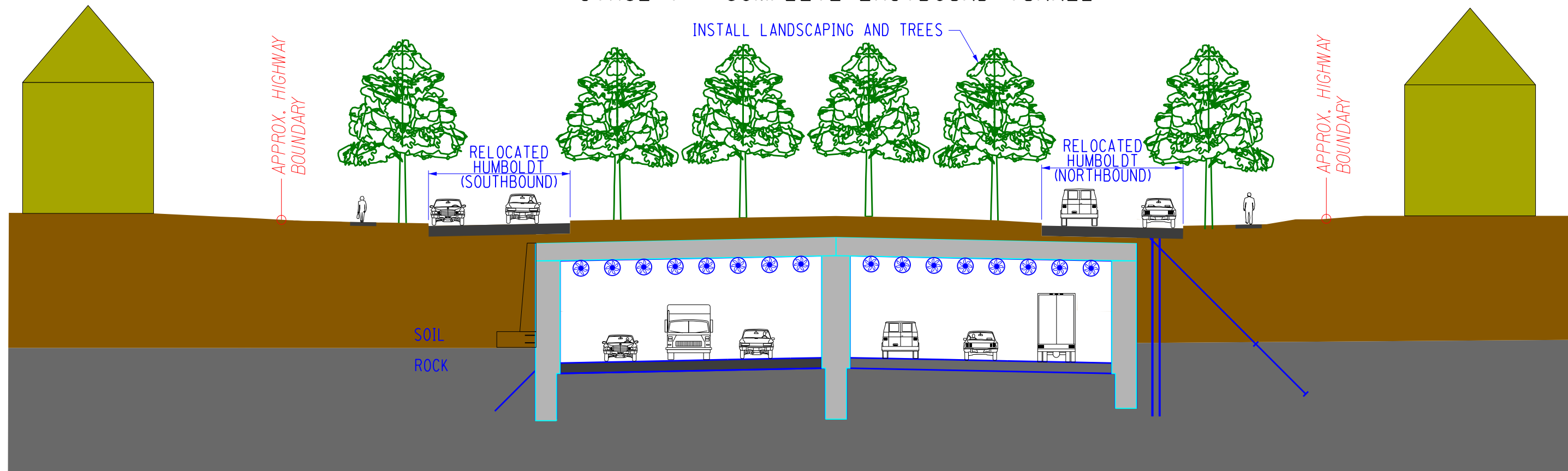

STAGE 8 - COMPLETE TUNNEL CONSTRUCTION



MATCH LINE - STA. L42 77+50

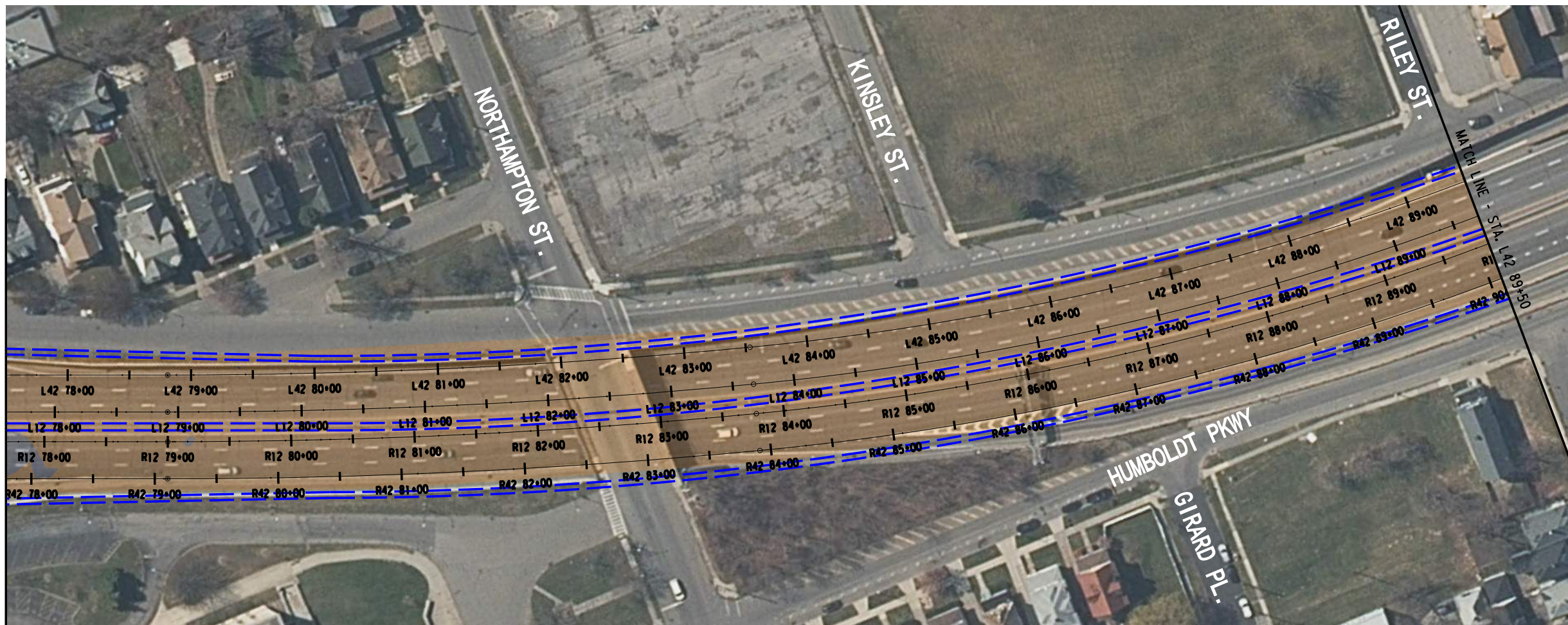

MATCH LINE - STA. L42 77+50

MATCH LINE - STA. L42 89+50

- LEGEND**
- CONVENTIONAL EXCAVATION - NO ROCK EXCAVATION EXPECTED
  - ROCK EXCAVATION LESS THAN 5 FT.
  - ROCK EXCAVATION IN EXCESS OF 5 FT.

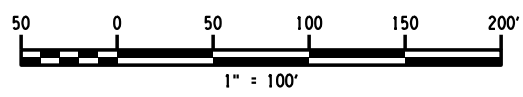

AS-BUILT REVISIONS DESCRIPTION OF ALTERATIONS:	
COUNTY:	REGION:

PIN	BRIDGES	CULVERTS

ALL DIMENSIONS IN ft UNLESS OTHERWISE NOTED		CONTRACT NUMBER
ROCK SURFACE PLAN		DRAWING NO. RPLN-1
		SHEET NO. 1

IT IS A VIOLATION OF LAW FOR ANY PERSON, UNLESS THEY ARE ACTING UNDER THE DIRECTION OF A LICENSED PROFESSIONAL ENGINEER, ARCHITECT, LANDSCAPE ARCHITECT, OR LAND SURVEYOR, TO ALTER AN ITEM IN ANY WAY. IF AN ITEM BEARING THE STAMP OF A LICENSED PROFESSIONAL IS ALTERED, THE ALTERING ENGINEER, ARCHITECT, LANDSCAPE ARCHITECT, OR LAND SURVEYOR SHALL STAMP THE DOCUMENT AND INCLUDE THE NOTATION "ALTERED BY" FOLLOWED BY THEIR SIGNATURE, THE DATE OF SUCH ALTERATION, AND A SPECIFIC DESCRIPTION OF THE ALTERATION.

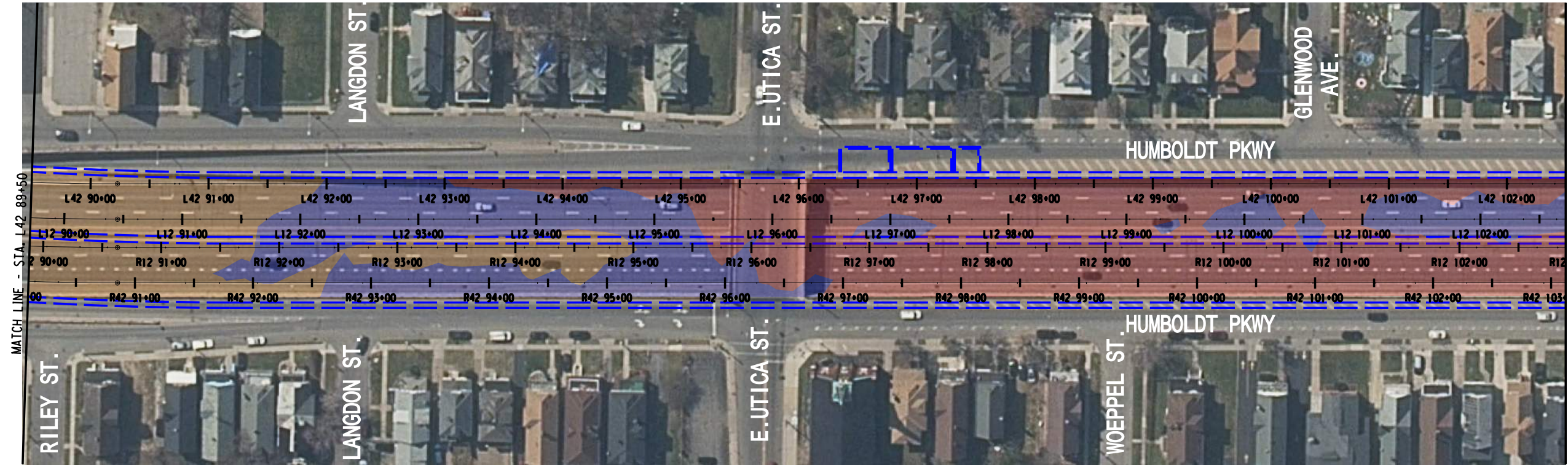

- LEGEND**
- CONVENTIONAL EXCAVATION - NO ROCK EXCAVATION EXPECTED
  - ROCK EXCAVATION LESS THAN 5 FT.
  - ROCK EXCAVATION IN EXCESS OF 5 FT.

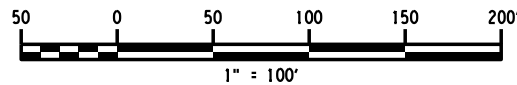

AS-BUILT REVISIONS DESCRIPTION OF ALTERATIONS:		PIN	BRIDGES	CULVERTS	ALL DIMENSIONS IN ft UNLESS OTHERWISE NOTED	CONTRACT NUMBER
					ROCK SURFACE PLAN	DRAWING NO. RPLN-2
						SHEET NO. 2

IT IS A VIOLATION OF LAW FOR ANY PERSON, UNLESS THEY ARE ACTING UNDER THE DIRECTION OF A LICENSED PROFESSIONAL ENGINEER, ARCHITECT, LANDSCAPE ARCHITECT, OR LAND SURVEYOR, TO ALTER AN ITEM IN ANY WAY. IF AN ITEM BEARING THE STAMP OF A LICENSED PROFESSIONAL IS ALTERED, THE ALTERING ENGINEER, ARCHITECT, LANDSCAPE ARCHITECT, OR LAND SURVEYOR SHALL STAMP THE DOCUMENT AND INCLUDE THE NOTATION "ALTERED BY" FOLLOWED BY THEIR SIGNATURE, THE DATE OF SUCH ALTERATION, AND A SPECIFIC DESCRIPTION OF THE ALTERATION.



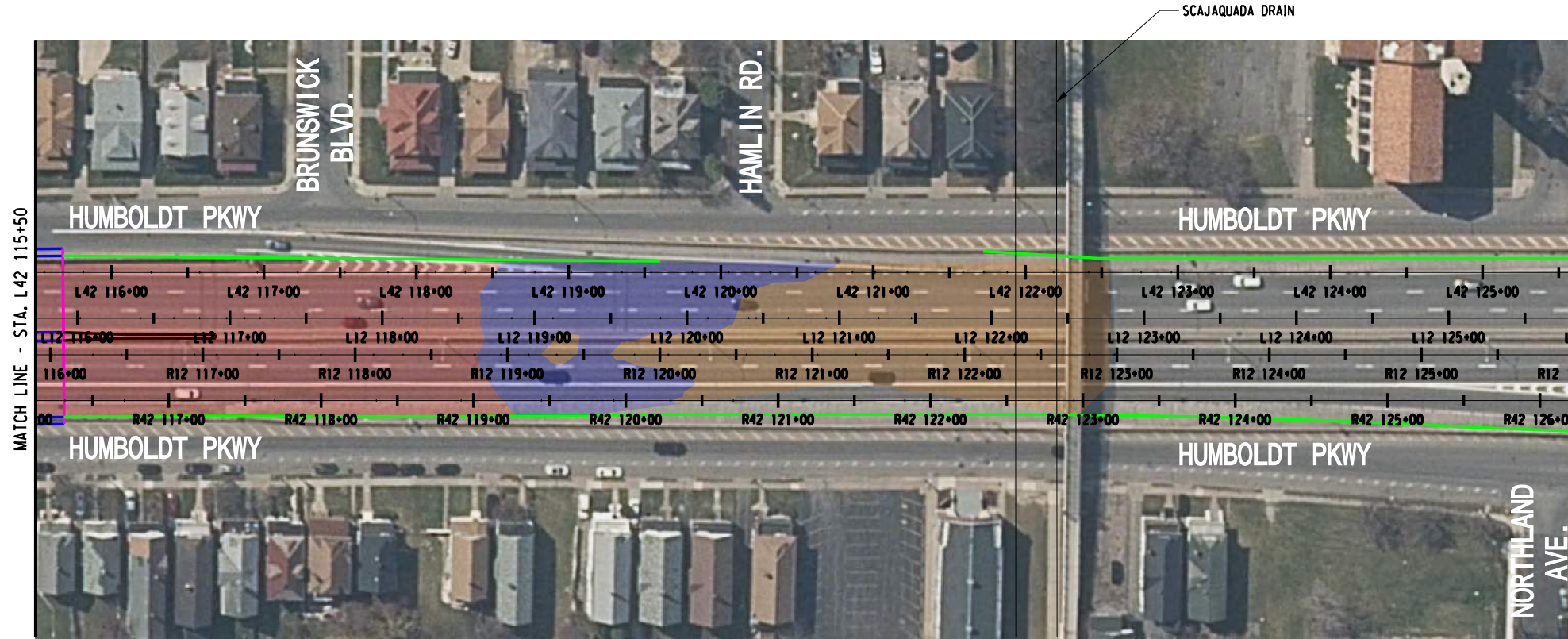

**LEGEND**

- CONVENTIONAL EXCAVATION - NO ROCK EXCAVATION EXPECTED
- ROCK EXCAVATION LESS THAN 5 FT.
- ROCK EXCAVATION IN EXCESS OF 5 FT.

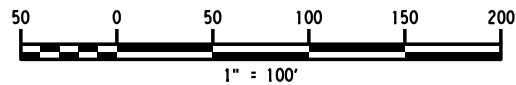

AS-BUILT REVISIONS DESCRIPTION OF ALTERATIONS:		PIN	BRIDGES	CULVERTS	ALL DIMENSIONS IN ft UNLESS OTHERWISE NOTED	CONTRACT NUMBER
	COUNTY: _____ REGION: _____					ROCK SURFACE PLAN
IT IS A VIOLATION OF LAW FOR ANY PERSON, UNLESS THEY ARE ACTING UNDER THE DIRECTION OF A LICENSED PROFESSIONAL ENGINEER, ARCHITECT, LANDSCAPE ARCHITECT, OR LAND SURVEYOR, TO ALTER AN ITEM IN ANY WAY. IF AN ITEM BEARING THE STAMP OF A LICENSED PROFESSIONAL IS ALTERED, THE ALTERING ENGINEER, ARCHITECT, LANDSCAPE ARCHITECT, OR LAND SURVEYOR SHALL STAMP THE DOCUMENT AND INCLUDE THE NOTATION "ALTERED BY" FOLLOWED BY THEIR SIGNATURE, THE DATE OF SUCH ALTERATION, AND A SPECIFIC DESCRIPTION OF THE ALTERATION.						
					 Powered by partnership.	 Department of Transportation



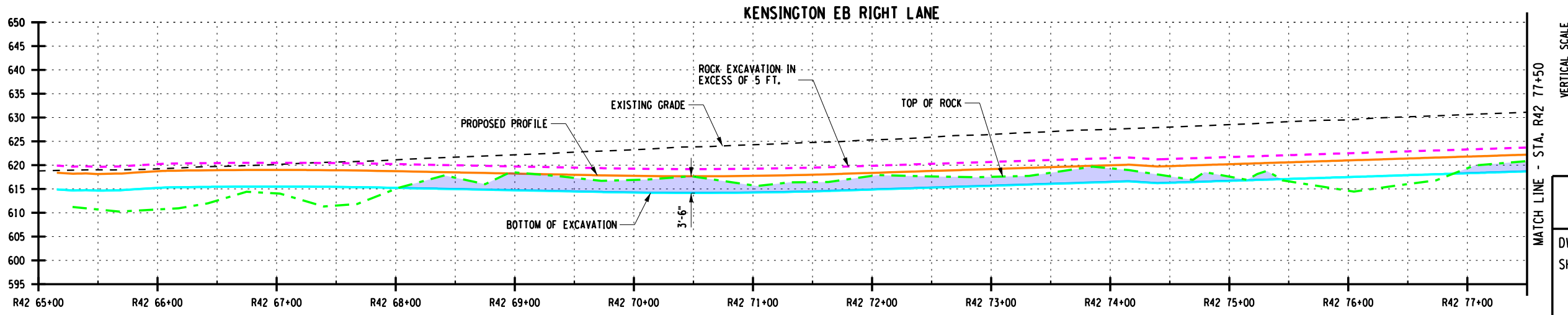
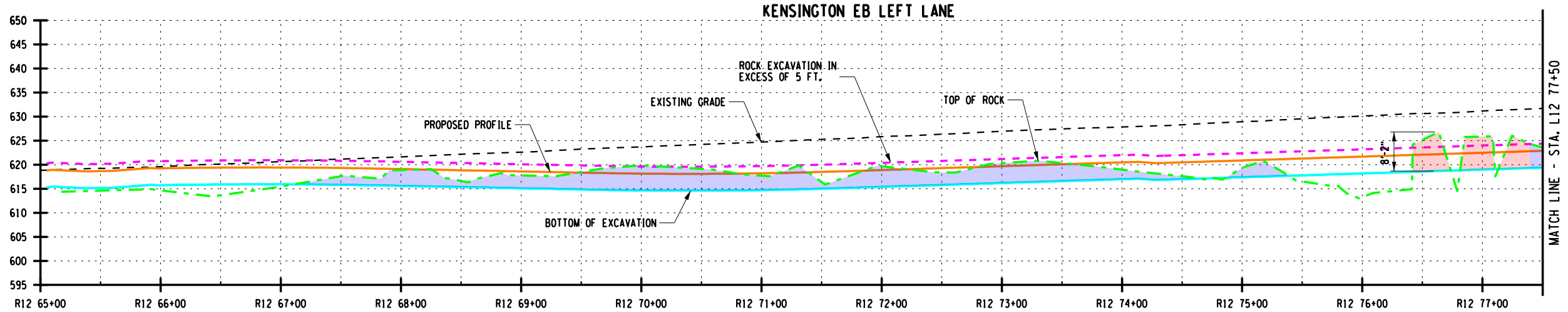
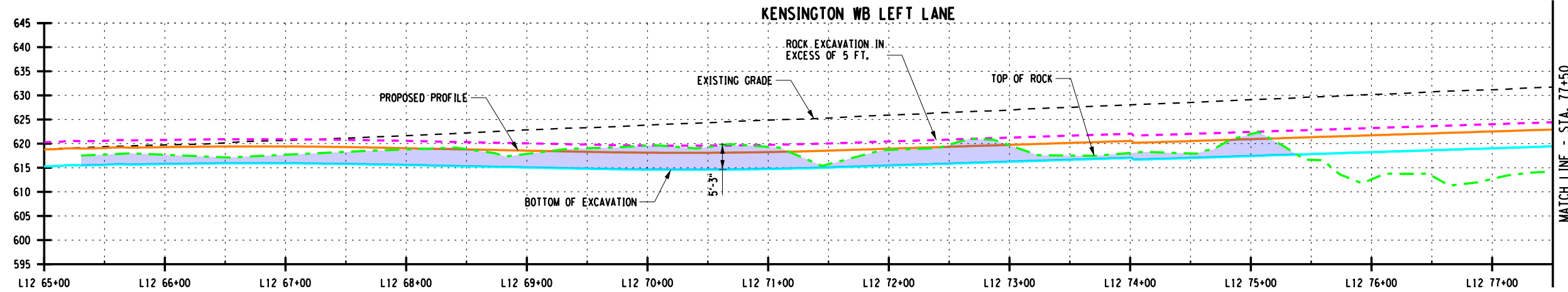
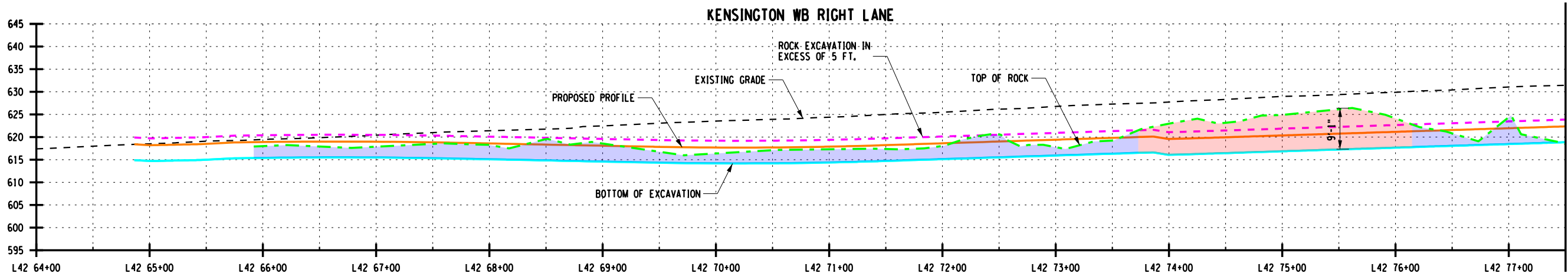

- LEGEND**
- EXISTING GRADE
  - TOP OF ROAD SURFACE
  - ROCK SURFACE BASED ON GPR AND EXISTING SOIL BORING INFO & RETAINING WALL INFO
  - BOTTOM OF EXCAVATION
  - ROCK EXCAVATION IN EXCESS OF 5 FT.
  - █ ROCK EXCAVATION LESS THAN 5 FT.
  - █ ROCK EXCAVATION IN EXCESS OF 5 FT.

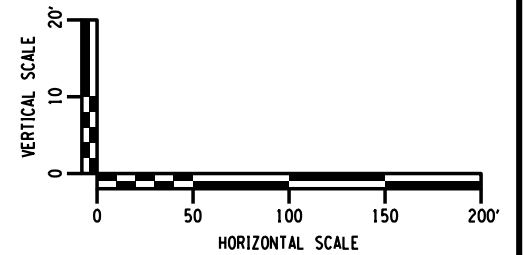

**ROCK SURFACE PROFILE**

DWG. NO. RPRO-1  
SHEET NO. 4

**Department of Transportation**  
**LaBella**  
Powered by partnership.

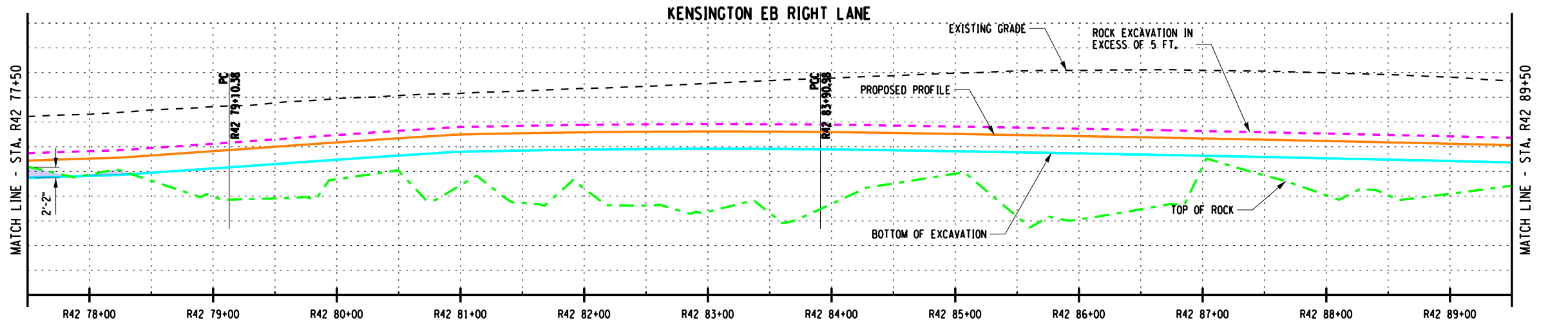
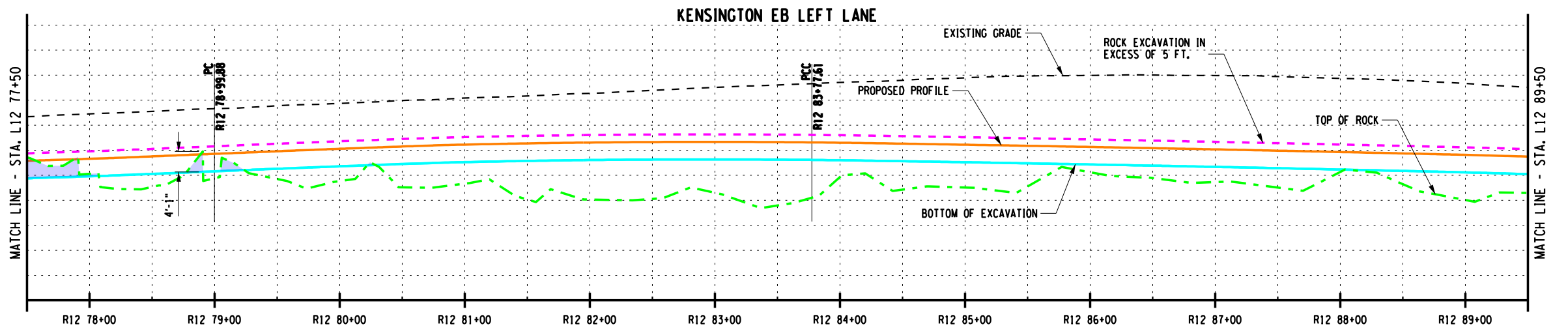
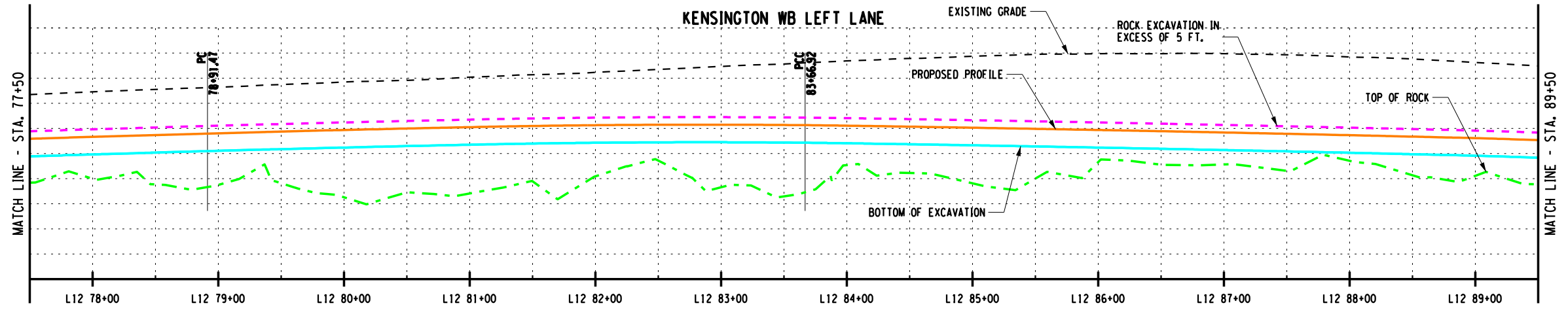
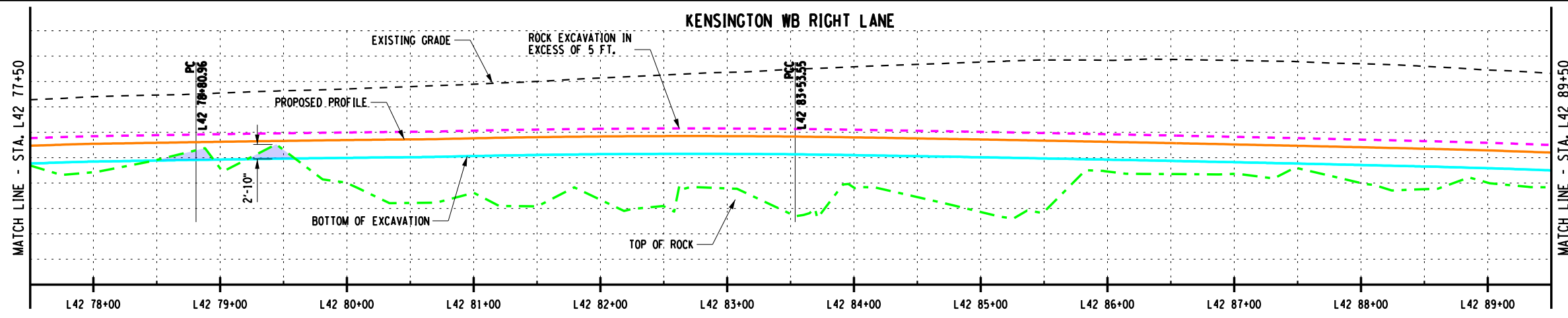

- LEGEND**
- - - EXISTING GRADE
  - TOP OF ROAD SURFACE
  - - - ROCK SURFACE BASED ON GPR AND EXISTING SOIL BORING INFO & RETAINING WALL INFO
  - BOTTOM OF EXCAVATION
  - - - ROCK EXCAVATION IN EXCESS OF 5 FT.
  - █ ROCK EXCAVATION LESS THAN 5 FT.
  - █ ROCK EXCAVATION IN EXCESS OF 5 FT.

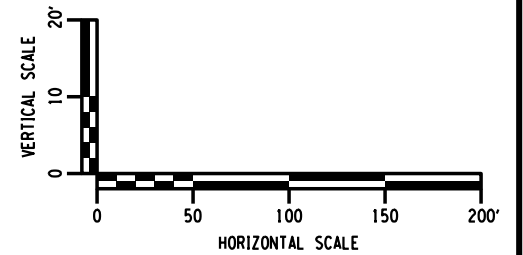

**ROCK SURFACE PROFILE**

DWG. NO. RPRO-2  
SHEET NO. 5

NEW YORK STATE OF OPPORTUNITY  
**Department of Transportation**

**LaBella**  
Powered by partnership.

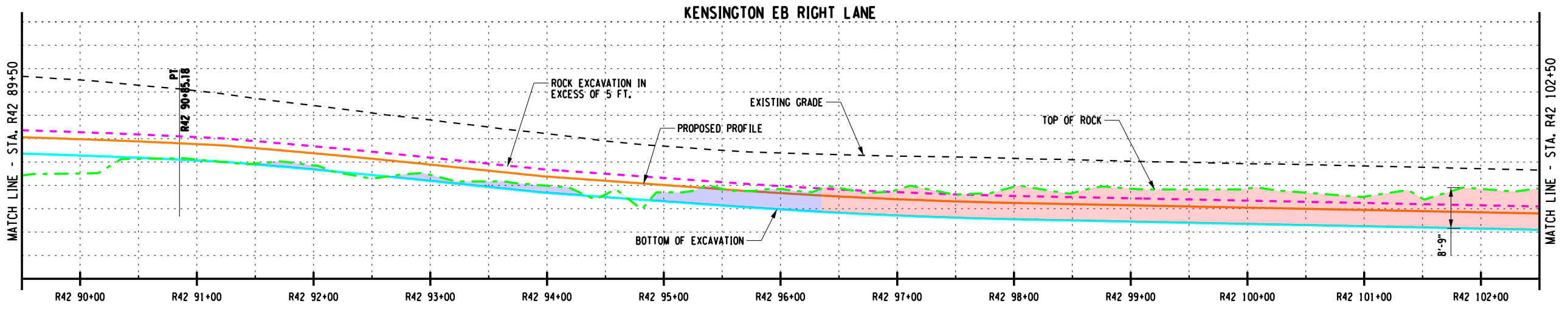
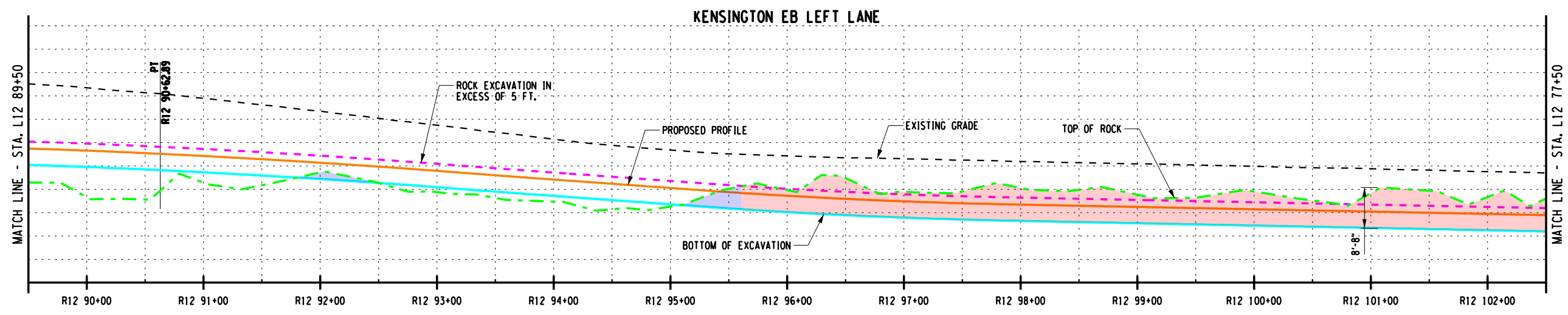
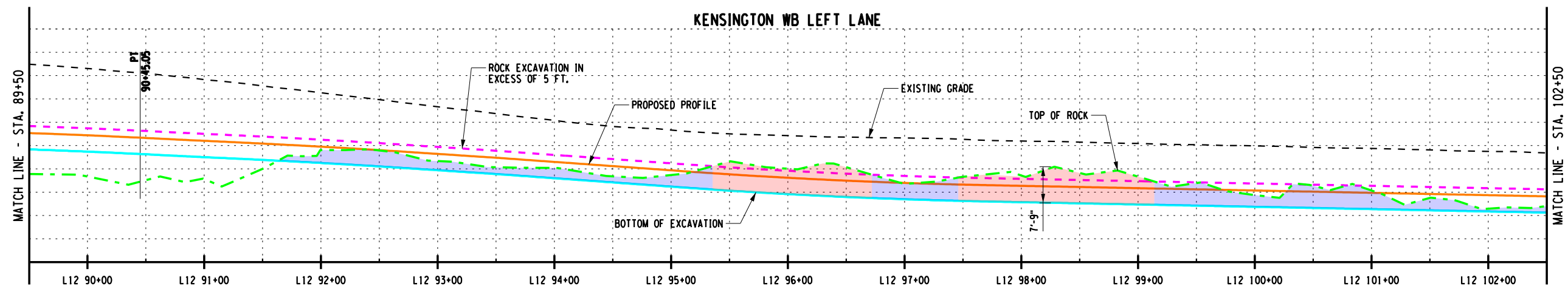
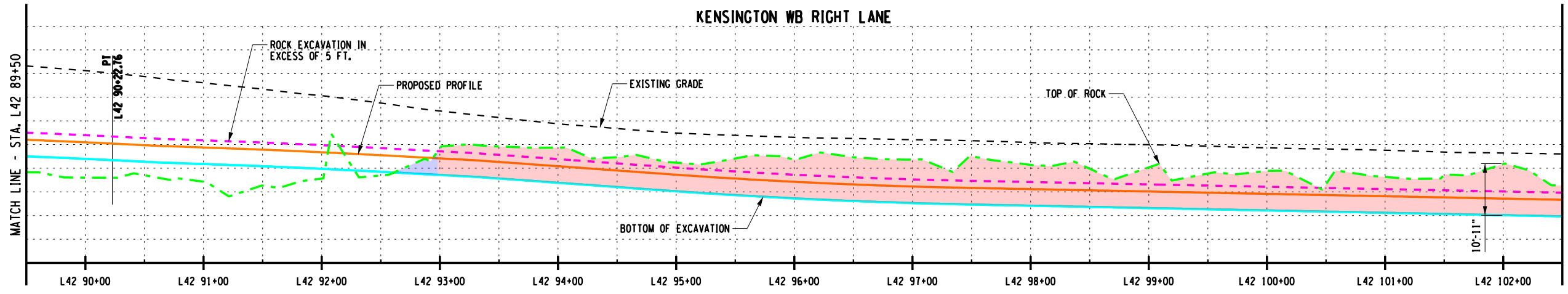

- LEGEND**
- - - EXISTING GRADE
  - TOP OF ROAD SURFACE
  - - - ROCK SURFACE BASED ON GPR AND EXISTING SOIL BORING INFO & RETAINING WALL INFO
  - BOTTOM OF EXCAVATION
  - - - ROCK EXCAVATION IN EXCESS OF 5 FT.
  - ROCK EXCAVATION LESS THAN 5 FT.
  - ROCK EXCAVATION IN EXCESS OF 5 FT.

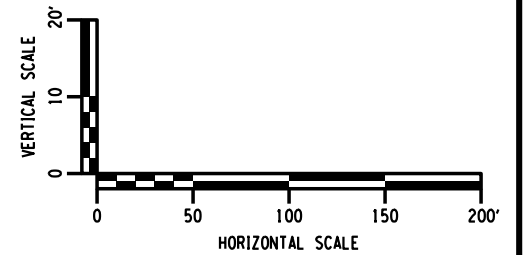

**ROCK SURFACE PROFILE**

DWG. NO. RPRO-3  
SHEET NO. 6

NEW YORK STATE OF OPPORTUNITY  
**Department of Transportation**

**LaBella**  
Powered by partnership.

KENSINGTON WB RIGHT LANE

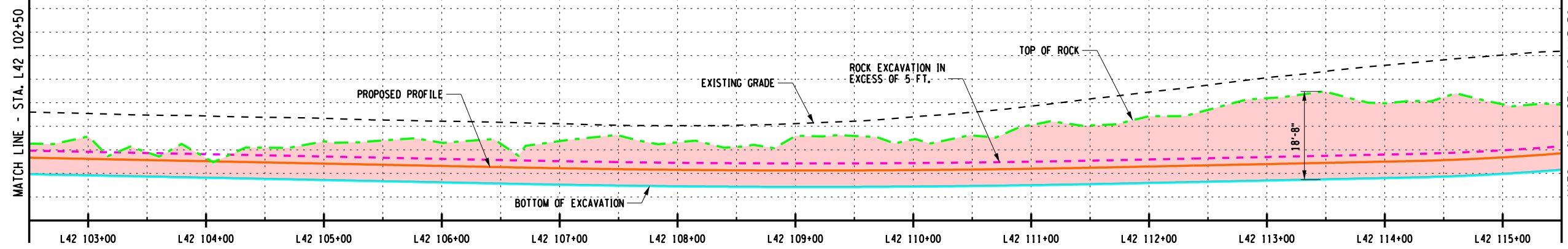

KENSINGTON WB LEFT LANE

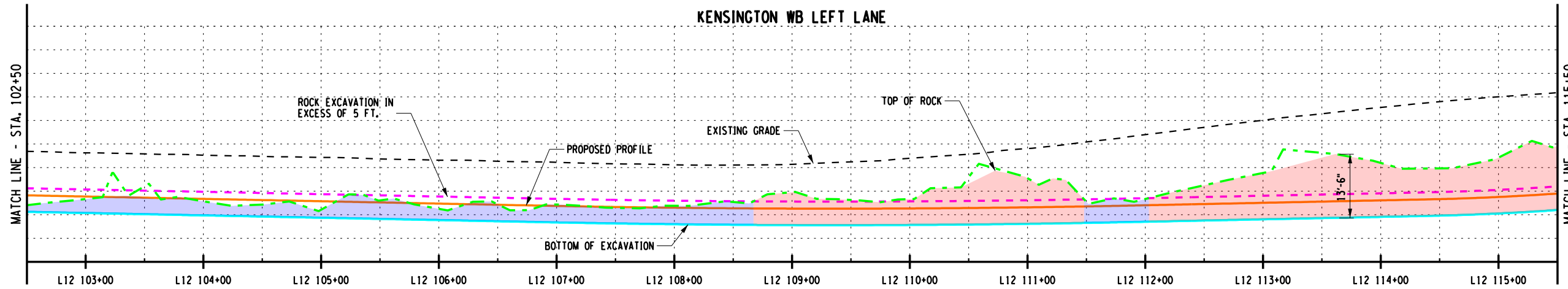

KENSINGTON EB LEFT LANE

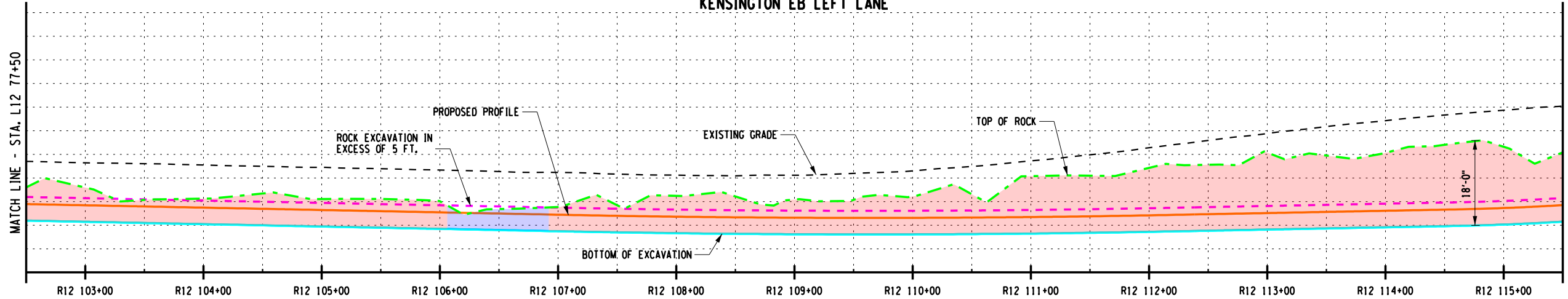

KENSINGTON EB RIGHT LANE

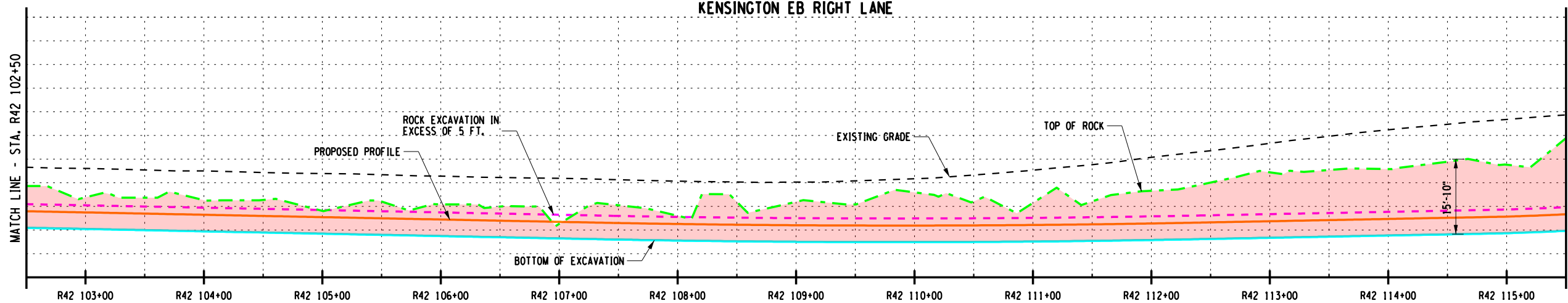

LEGEND

- - - EXISTING GRADE
- TOP OF ROAD SURFACE
- · - · - · - ROCK SURFACE BASED ON GPR AND EXISTING SOIL BORING INFO & RETAINING WALL INFO
- BOTTOM OF EXCAVATION
- · - · - · - ROCK EXCAVATION IN EXCESS OF 5 FT.
- █ ROCK EXCAVATION LESS THAN 5 FT.
- █ ROCK EXCAVATION IN EXCESS OF 5 FT.

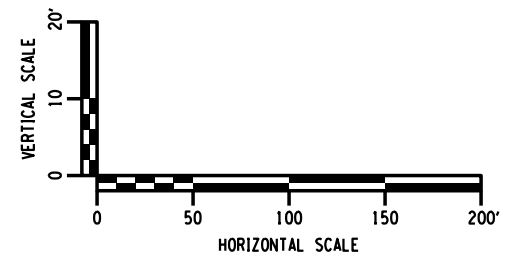

ROCK SURFACE PROFILE

DWG. NO. RPRO-4  
SHEET NO. 7



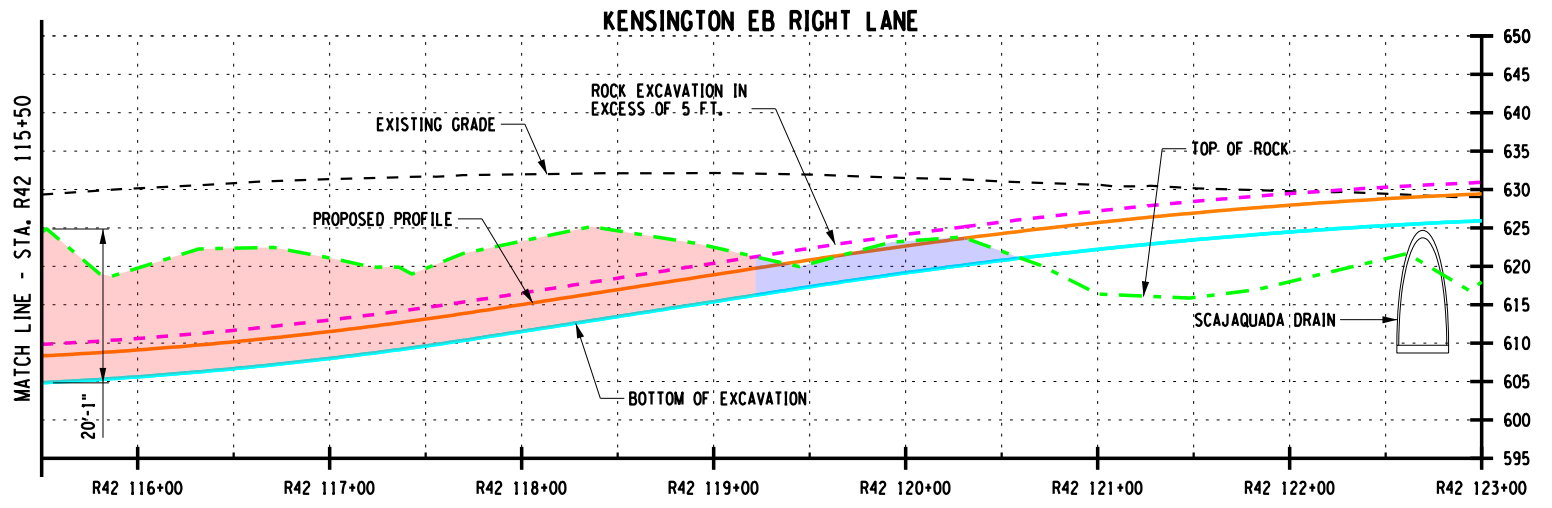
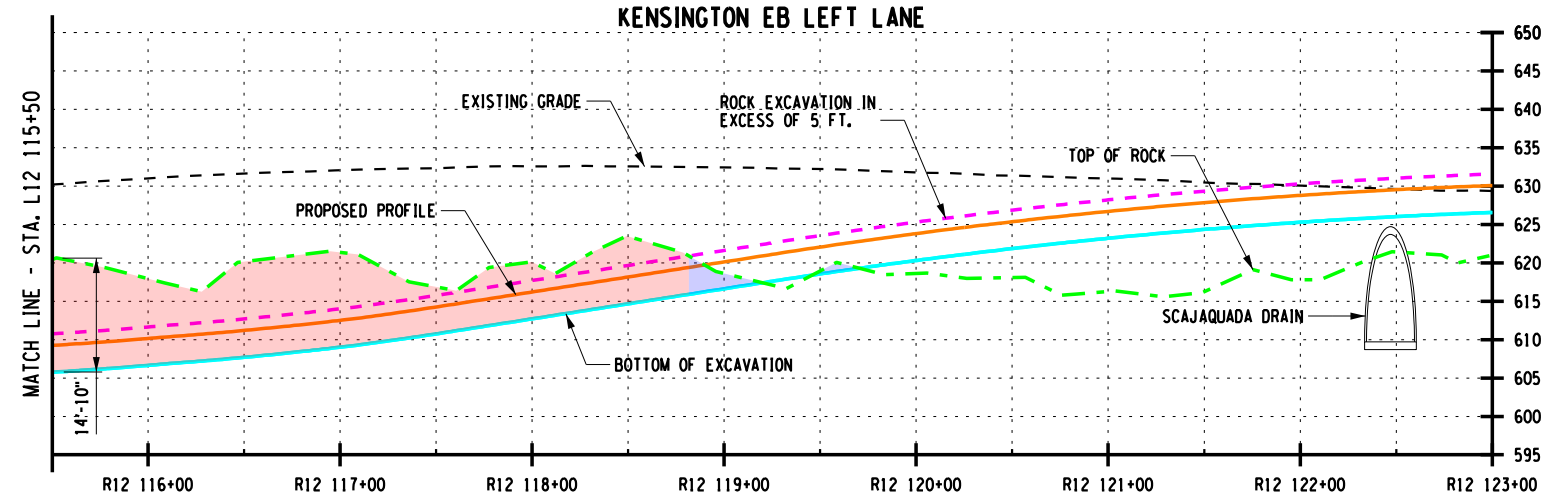
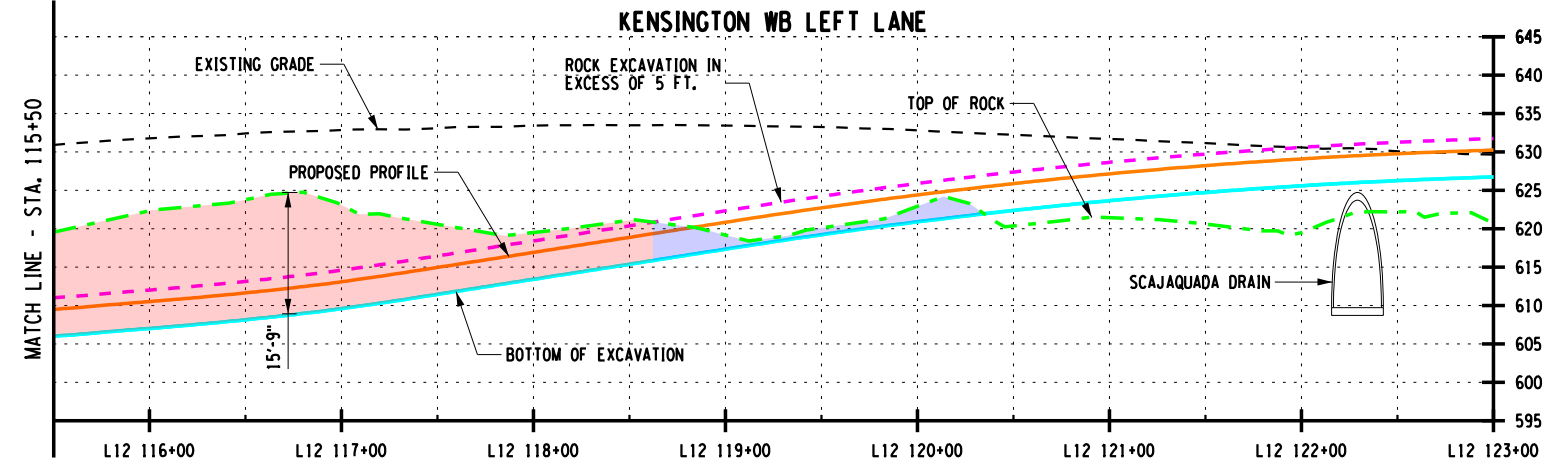
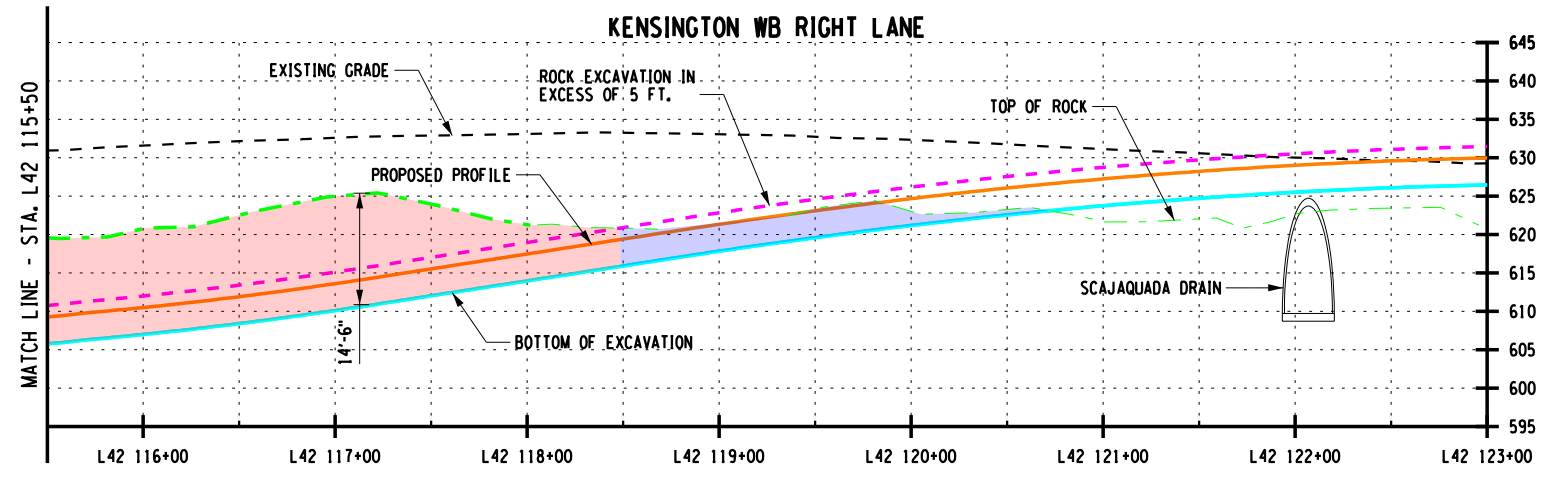

- LEGEND**
- - - EXISTING GRADE
  - TOP OF ROAD SURFACE
  - - - ROCK SURFACE BASED ON GPR AND EXISTING SOIL BORING INFO & RETAINING WALL INFO
  - BOTTOM OF EXCAVATION
  - - - ROCK EXCAVATION IN EXCESS OF 5 FT.
  - █ ROCK EXCAVATION LESS THAN 5 FT.
  - █ ROCK EXCAVATION IN EXCESS OF 5 FT.

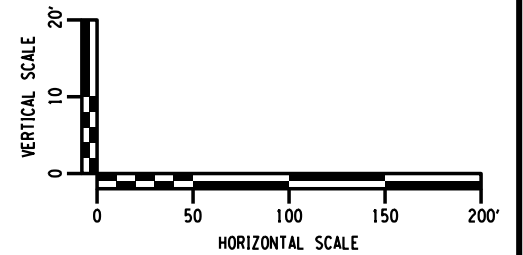

ROCK SURFACE PROFILE

DWG. NO. RPRO-5  
SHEET NO. 8

NEW YORK STATE OF OPPORTUNITY  
**Department of Transportation**

**LaBella**  
Powered by partnership.

# Construction Staging Sections

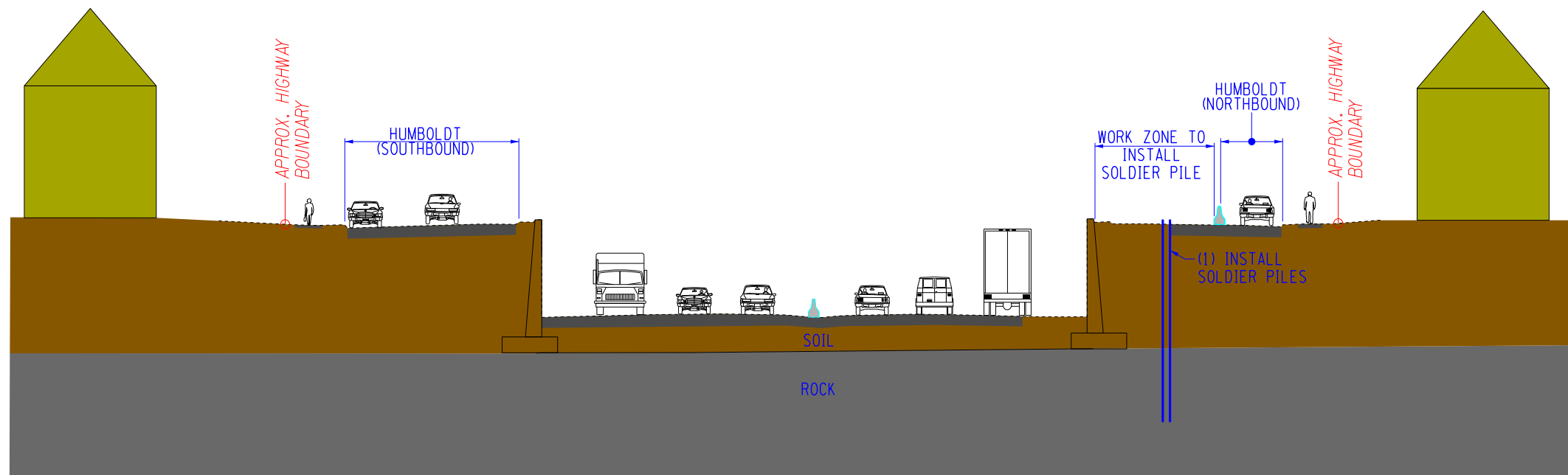

STAGE 1 - CONSTRUCT EASTBOUND TUNNEL WALLS AND ROADWAY

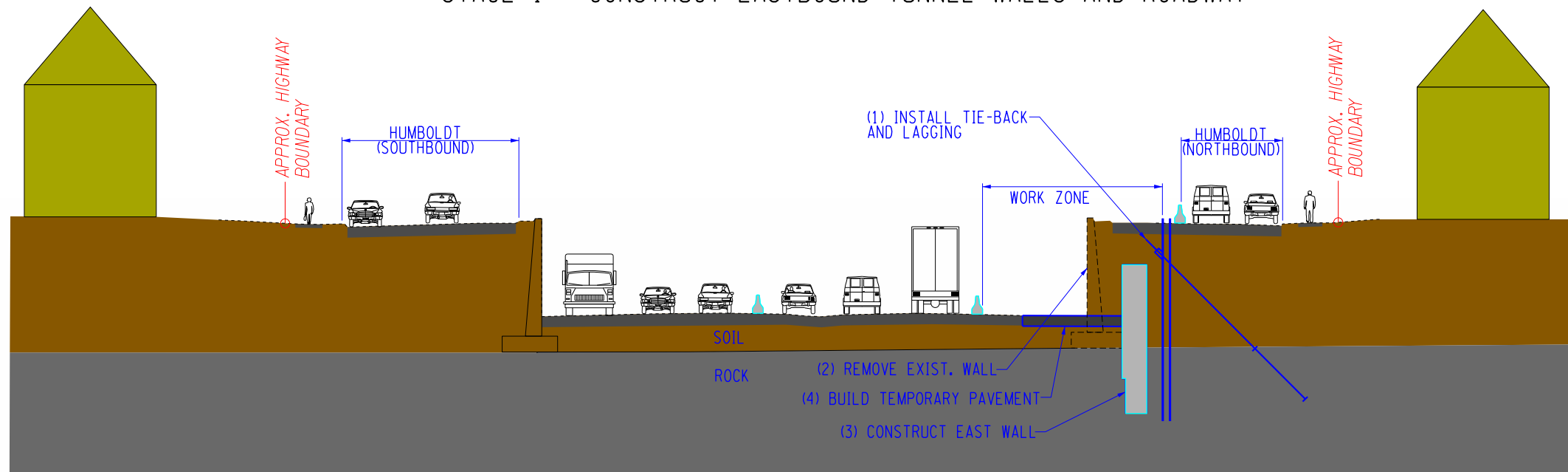

STAGE 2 - CONSTRUCT EASTBOUND TUNNEL WALLS AND ROADWAY

## Stage 1 traffic notes:

- 1) Humboldt SB operates normally
- 2) Kensington operates normally
- 3) Humboldt NB temp. impacts

## Stage 2 traffic notes:

- 1) Humboldt SB operates normally
- 2) Kensington operates normally (shifted, reduced shoulder)
- 3) Humboldt NB (reduced width)



Office of the  
Governor

KATHY HOCHUL  
Governor



NEW YORK  
STATE OF  
OPPORTUNITY  
Department of  
Transportation

MARIE THERESE DOMINGUEZ  
Commissioner



# Construction Staging Sections

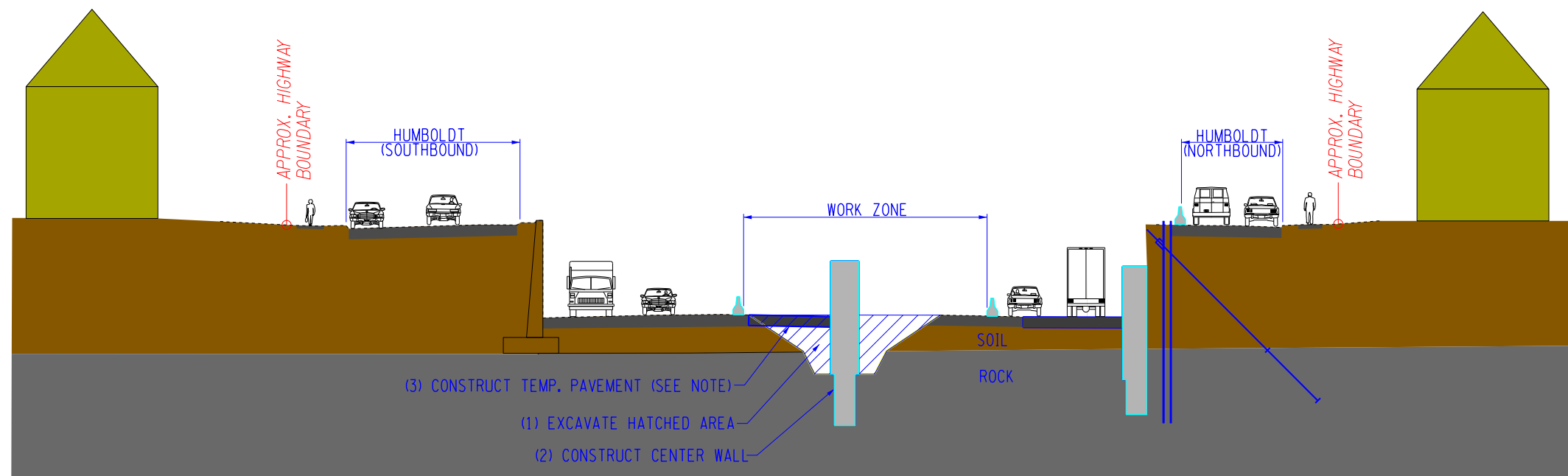

NOTE: TEMP. PAVEMENT IS REQUIRED FOR STAGE 4 TRAFFIC

STAGE 3 - CONSTRUCT EASTBOUND TUNNEL WALLS AND ROADWAYS

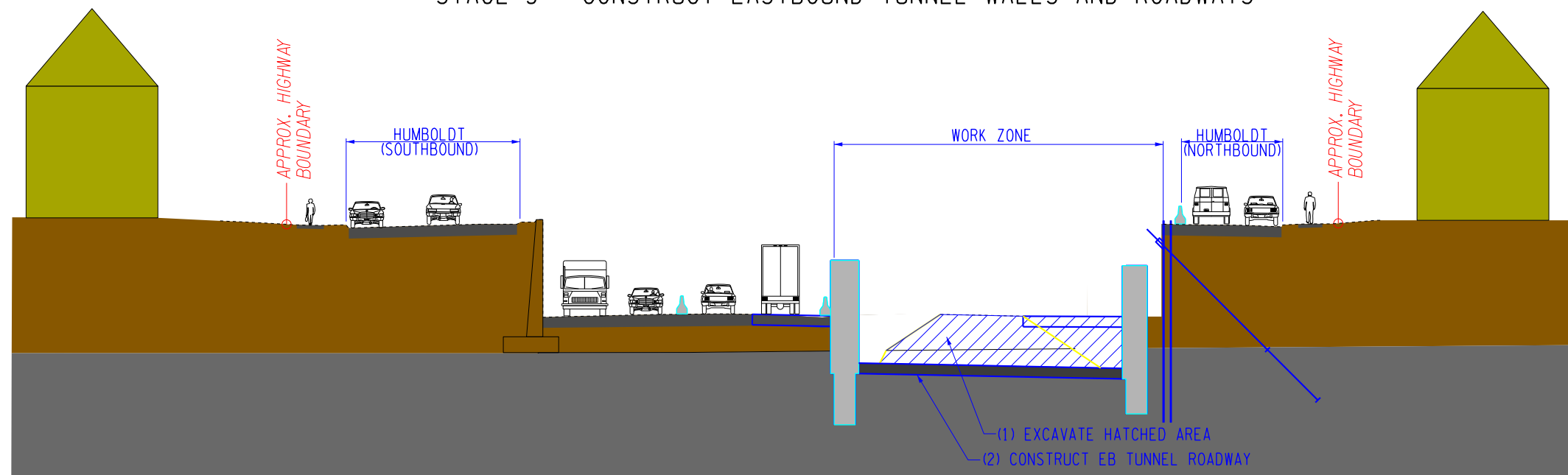

STAGE 4 - CONSTRUCT EASTBOUND TUNNEL WALLS AND ROADWAY

## Stage 3 traffic notes:

- 1) Humboldt SB operates normally
- 2) Kensington 2-lanes each direction (as-shown)
- 3) Humboldt NB (reduced width)

## Stage 4 traffic notes:

- 1) Humboldt SB operates normally
- 2) Kensington 2-lanes each direction (as-shown)
- 3) Humboldt NB (reduced width)



Office of the  
Governor

KATHY HOCHUL  
Governor



Department of  
Transportation

MARIE THERESE DOMINGUEZ  
Commissioner



# Construction Staging Sections

## Stage 5 traffic notes:

- 1) Humboldt SB operates normally
- 2) Kensington 2-lanes each direction (as-shown)
- 3) Humboldt NB (reduced width)

## Stage 6 traffic notes:

- 1) Humboldt SB operates normally
- 2) Kensington 2-lanes each direction (as-shown)
- 3) Humboldt NB (reduced width)

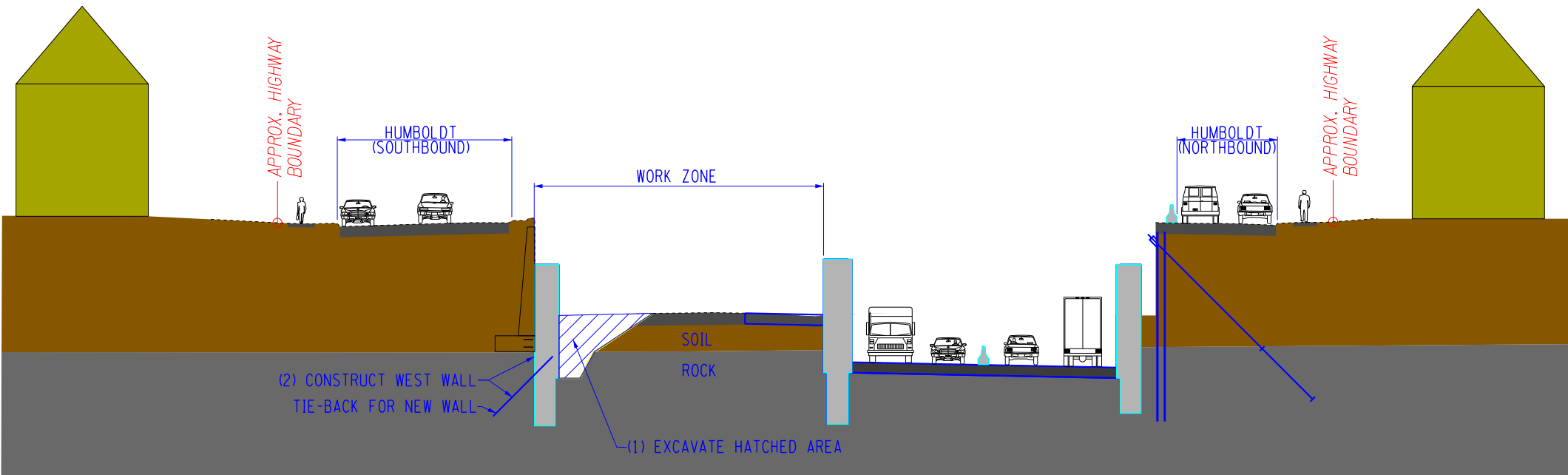

STAGE 5 - CONSTRUCT WESTBOUND TUNNEL

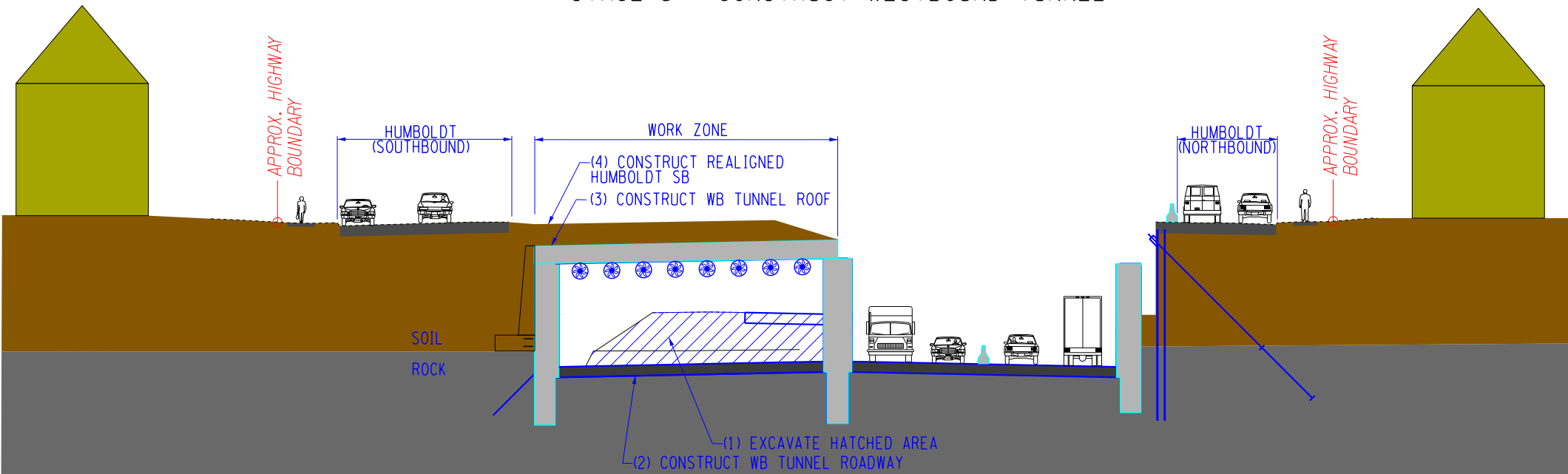

STAGE 6 - COMPLETE WESTBOUND TUNNEL



Office of the  
Governor

KATHY HOCHUL  
Governor



Department of  
Transportation

MARIE THERESE DOMINGUEZ  
Commissioner





# Construction Staging Sections

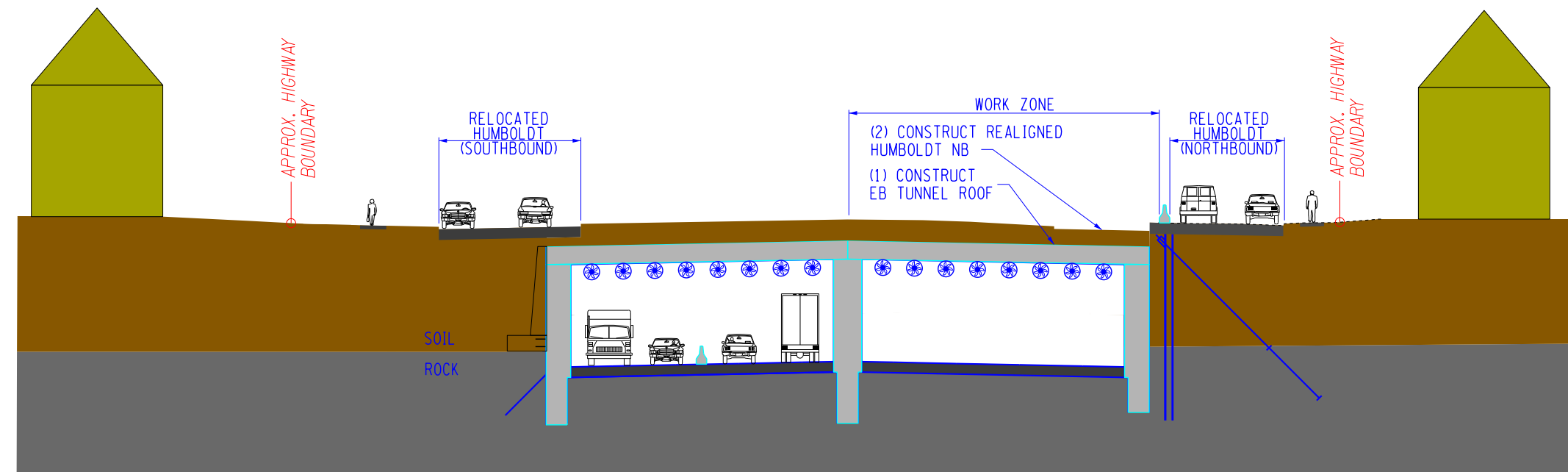

STAGE 7 - COMPLETE EASTBOUND TUNNEL

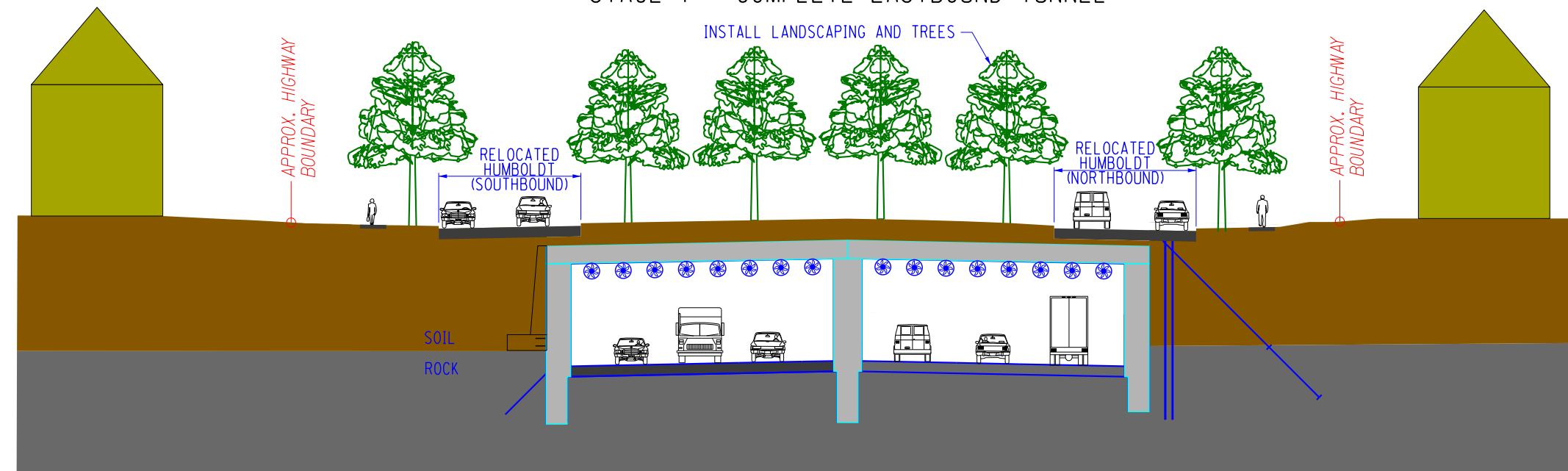

STAGE 8 - COMPLETE TUNNEL CONSTRUCTION

## Stage 7 traffic notes:

- 1) Humboldt SB operates normally
- 2) Kensington 2-lanes each direction (as-shown)
- 3) Humboldt NB (reduced width)

## Stage 8 traffic notes:

- 1) Humboldt SB operates normally
- 2) Kensington 3-lanes each direction (as-shown)
- 3) Humboldt NB operates normally



Office of the  
Governor

KATHY HOCHUL  
Governor



Department of  
Transportation

MARIE THERESE DOMINGUEZ  
Commissioner



# Example Construction Staging Plan

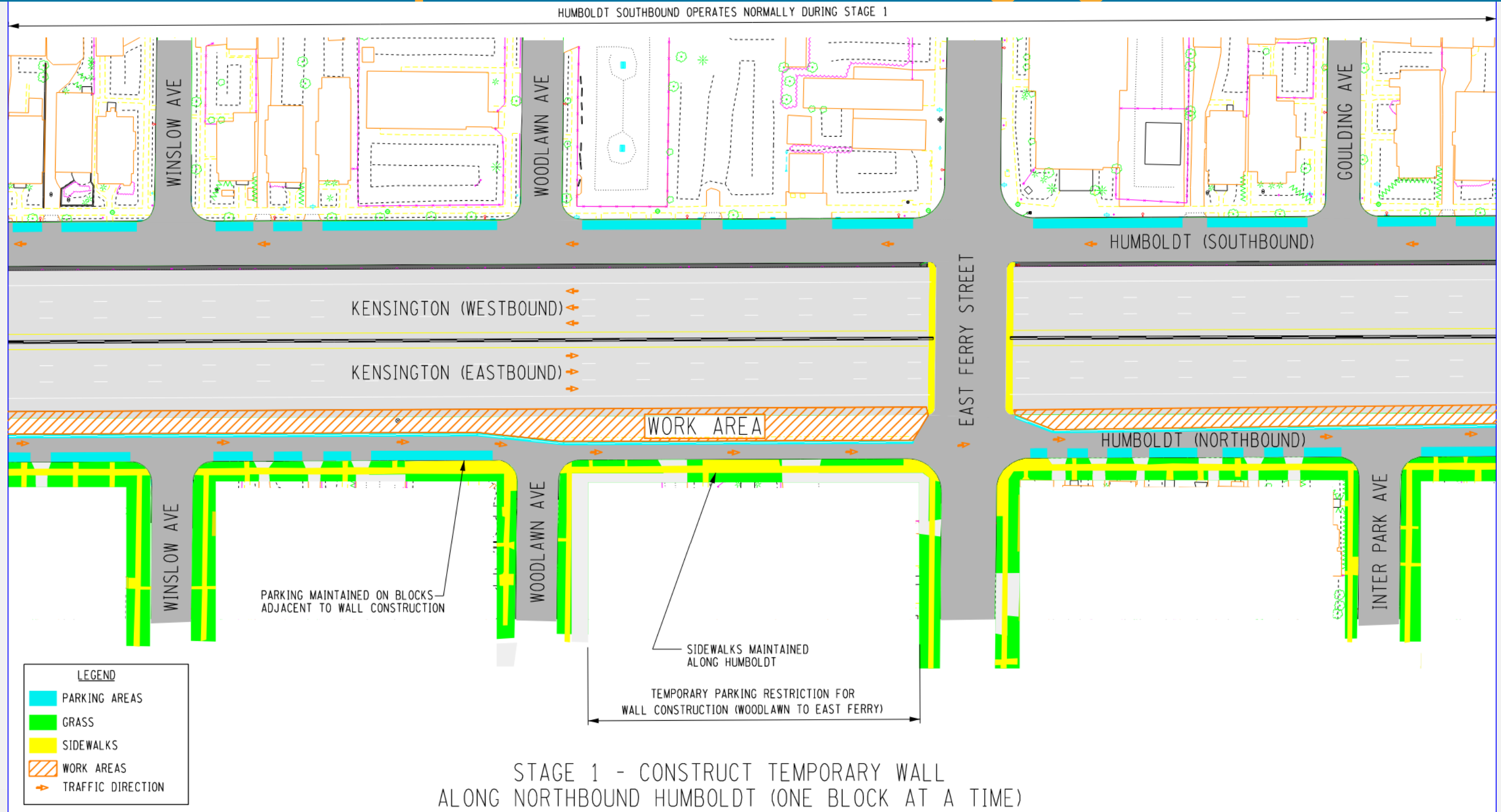

Office of the Governor

KATHY HOCHUL  
Governor



MARIE TERESE DOMINGUEZ  
Commissioner

Department of Transportation

